

DIMENSIONS FOR OVERALL HEIGHT AND LENGTH ARE APPROXIMATE
 OVERALL HEIGHT = 110"
 OVERALL WIDTH WITH RUB
 RAILS & FENDERETTES = 98"

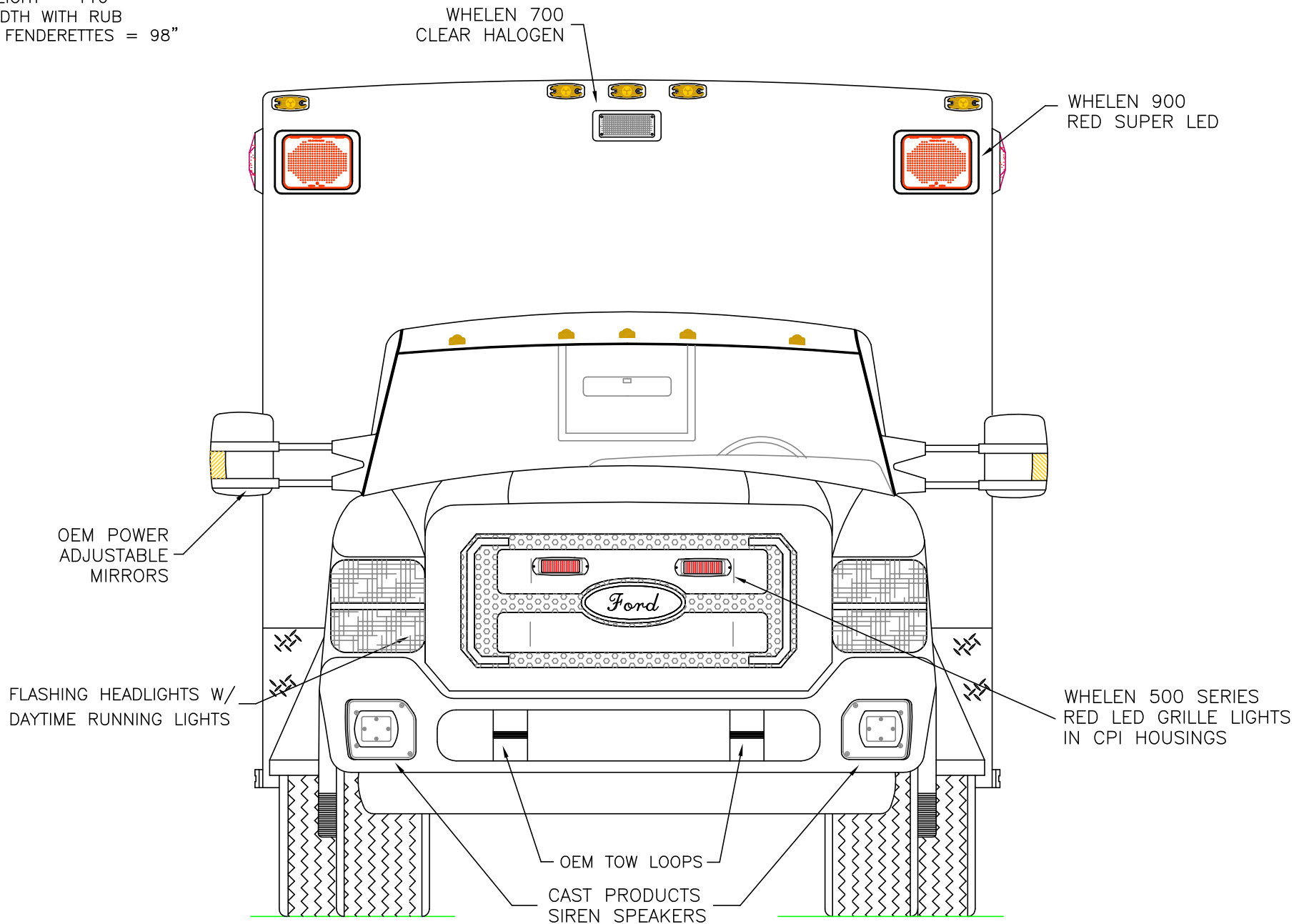

THIS DRAWING IS FOR REPRESENTATIONAL PURPOSES ONLY. DETAILS ARE CONCEPTUAL AND ARE SUBJECT TO CHANGE DURING DESIGN AND CONSTRUCTION
 DIMENSIONS ARE APPROXIMATE UNLESS NOTED OTHERWISE TO MEET A SPECIFIC CUSTOMER NEED.



2012 FRONT EXTERIOR VIEW
 CHIEF XL-1/F-450 CHASSIS

DATE:		DRAWING NO.	
05 JULY 11		XLF450-1	
DWG.	REV.		
GLF	NR		

1:17

DIMENSIONS FOR OVERALL HEIGHT AND LENGTH ARE APPROXIMATE
 OVERALL HEIGHT = 110"
 OVERALL WIDTH WITH RUB
 RAILS & FENDERETTES = 98"

CAST PRODUCTS
 DOOR GRABBERS

LED LICENSE
 PLATE LIGHT

MUD FLAPS

(1) WHELEN 900 AMBER SUPER LED

(2) WHELEN 900 CLEAR HALOGEN LOAD LIGHTS

(2) WHELEN 900
 RED SUPER LED

ONE (1) EACH SIDE
 WHELEN
 600 LED BRAKE/TAIL,
 600 LED TURN
 600 HALOGEN BACK-UP

COT PROTECTOR
 ON STEP EDGE

INDEPENDENT BUMPER WITH
 FLIP-UP CENTER STEP AND
 TOW HOOKS

THIS DRAWING IS FOR REPRESENTATIONAL PURPOSES ONLY. DETAILS ARE CONCEPTUAL AND ARE SUBJECT TO CHANGE DURING DESIGN AND CONSTRUCTION
 DIMENSIONS ARE APPROXIMATE UNLESS NOTED OTHERWISE TO MEET A SPECIFIC CUSTOMER NEED.



2012 REAR EXTERIOR VIEW
 CHIEF XL-1/F-450 CHASSIS

DATE:	05 JULY 11
DWG.	REV.
GLF	NR

DRAWING NO.
XLF450-2

1:16

DIMENSIONS FOR OVERALL HEIGHT AND LENGTH ARE APPROXIMATE
 OVERALL HEIGHT = 110"
 OVERALL LENGTH = 298.5"
 MODULE LENGTH = 166"

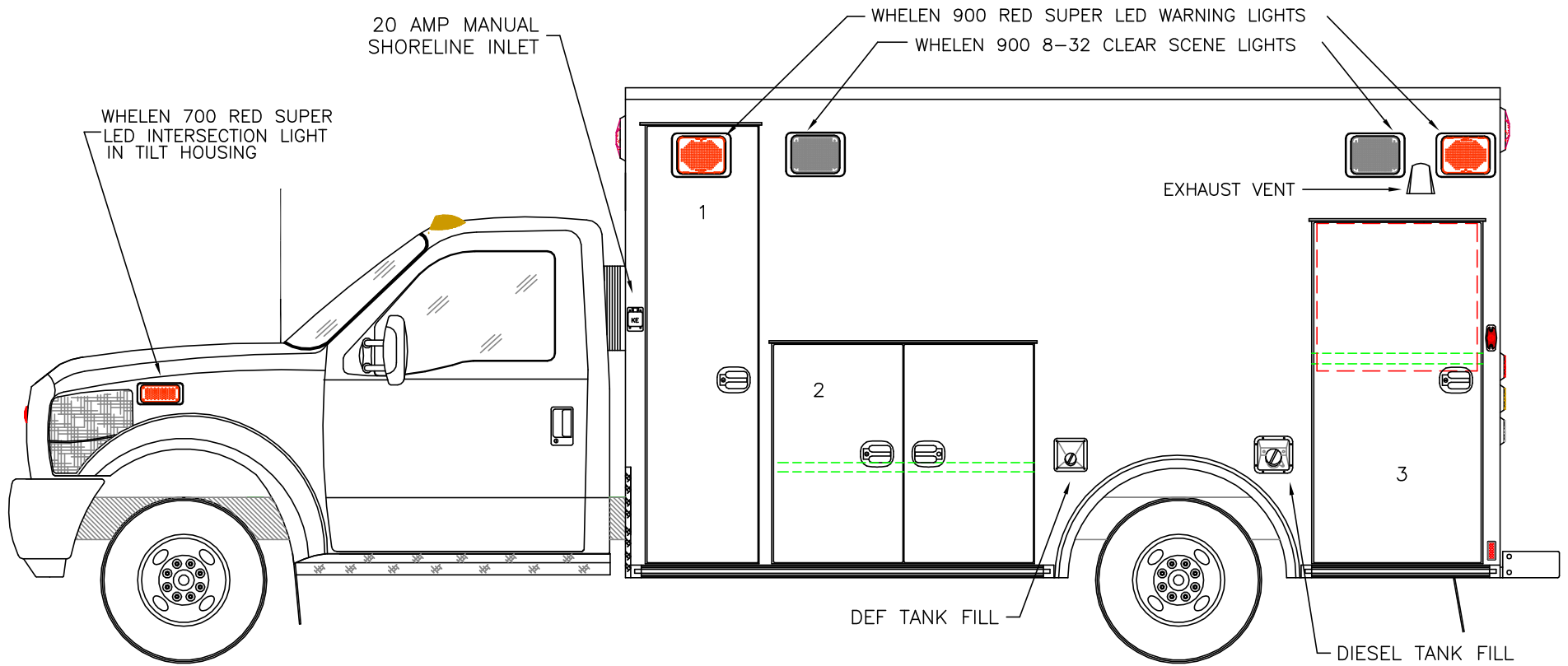

COMPARTMENT

O.S.S #1

CLEAR OPENING: 81.75h x 17.75w
 INSIDE DIM'S.: 82.75h x 22.25w x 20.75d

O.S.S #2

CLEAR OPENING: 40.25h x 45.75w
 INSIDE DIM'S.: 43.75h x 50.00w x 20.75d
 ONE (1) ADJUSTABLE SHELF

O.S.S #3

CLEAR OPENING: 63.50h x 28.75w
 INSIDE DIM'S.: 65.25h x 32.75w x 20.75d
 INSIDE/OUTSIDE ACCESS
 ONE (1) ADJUSTABLE SHELF

THIS DRAWING IS FOR REPRESENTATIONAL PURPOSES ONLY. DETAILS ARE CONCEPTUAL AND ARE SUBJECT TO CHANGE DURING DESIGN AND CONSTRUCTION
 DIMENSIONS ARE APPROXIMATE UNLESS NOTED OTHERWISE TO MEET A SPECIFIC CUSTOMER NEED.



2012 STREETSIDE EXTERIOR VIEW
 CHIEF XL-1/F-450 CHASSIS

DATE:		DRAWING NO.	
09 AUG 11		XLF450-3	
DWG.	REV.		
GLF	NR		

1:30

DIMENSIONS FOR OVERALL HEIGHT AND LENGTH ARE APPROXIMATE
 OVERALL HEIGHT = 110"
 OVERALL LENGTH = 298.5"
 MODULE LENGTH = 166"

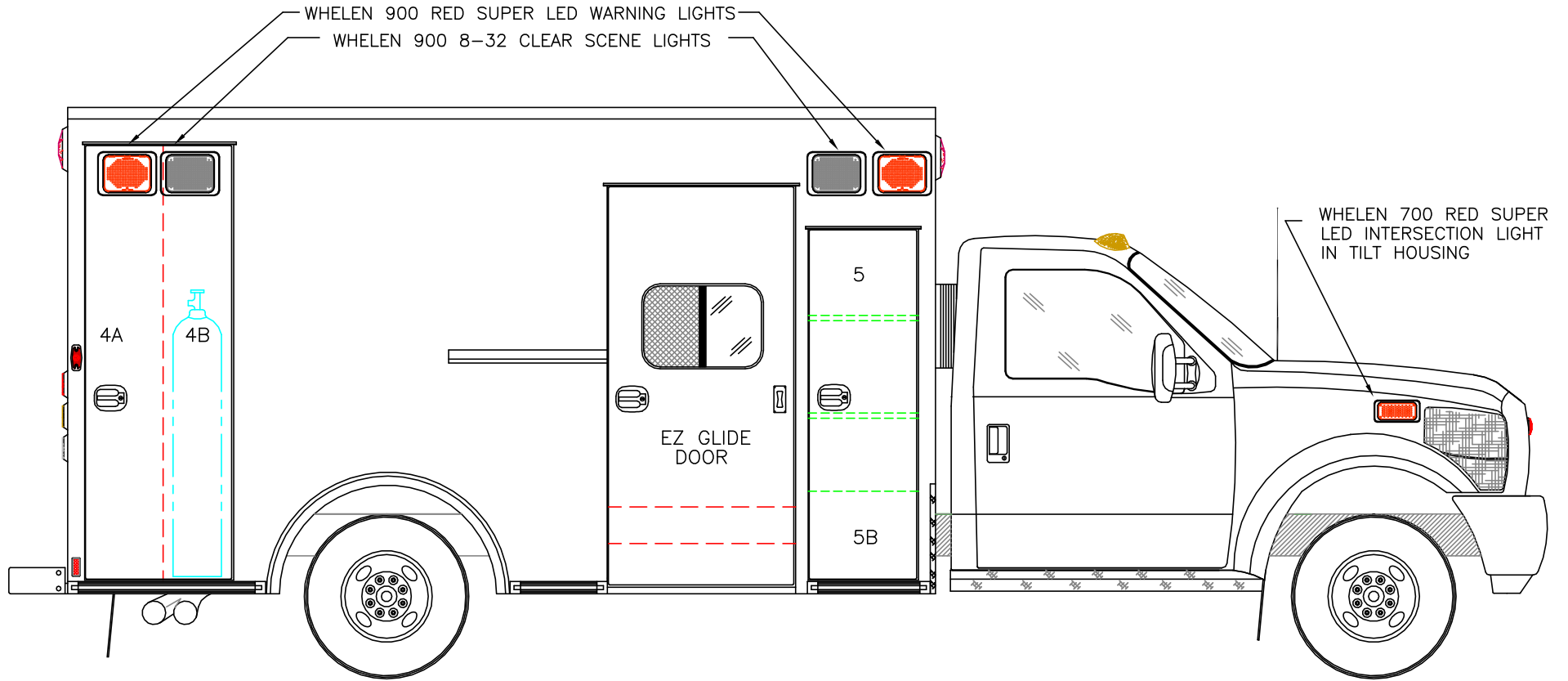

COMPARTMENT
 O.S.S #4

CLEAR OPENING: 81.75h x 24.75w
 INSIDE DIM'S. 4A: 82.75h x 15.00w x 20.75d
 BACKBOARD/SCOOP STORAGE
 INSIDE DIM'S. 4B: 82.75h x 13.50w x 12.00d
 OXYGEN CYLINDER STORAGE

O.S.S #5

CLEAR OPENING: 65.50h x 17.50w
 INSIDE DIM'S. 5A: SEE PARTITION INTERIOR VIEW
 INSIDE/OUTSIDE STORAGE WITH TWO (2) ADJUSTABLE SHELVES

INSIDE DIM'S. 5B: 16.50h x 17.50w x 17.00d

THIS DRAWING IS FOR REPRESENTATIONAL PURPOSES ONLY. DETAILS ARE CONCEPTUAL AND ARE SUBJECT TO CHANGE DURING DESIGN AND CONSTRUCTION
 DIMENSIONS ARE APPROXIMATE UNLESS NOTED OTHERWISE TO MEET A SPECIFIC CUSTOMER NEED.



2012 CURBSIDE EXTERIOR VIEW
 CHIEF XL-1/F-450 CHASSIS

DATE:		DRAWING NO.	
05 JULY 11		XLF450-4	
DWG.	REV.		
GLF	NR		

1:30

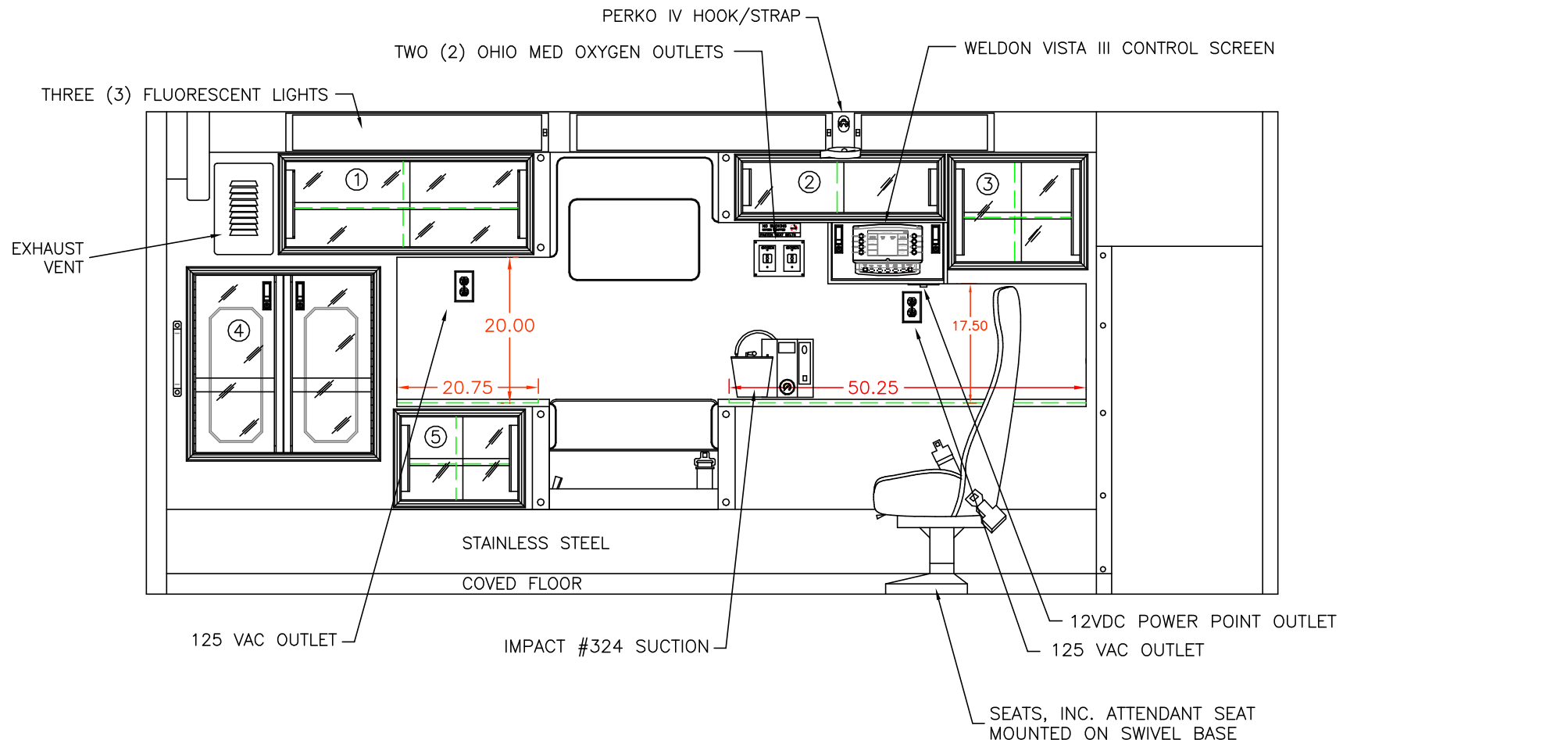

COMPARTMENT

- #1 DOOR OPENING: 12.50h x 35.25w
INSIDE DIMS: 14.25h x 37.00w x 17.25d
ONE (1) ADJUSTABLE SHELF
- #2 DOOR OPENING: 7.50h x 28.75w
INSIDE DIMS: 9.25h x 30.50w x 17.25d
- #3 DOOR OPENING: 14.75h x 18.50w
INSIDE DIMS: 18.00h x 20.25w x 17.25d
ONE (1) ADJUSTABLE SHELF

- #4 DOOR OPENING: 26.25h x 26.25w
INSIDE DIMS: O.S.S. #3
RECESSED .375" ACRYLIC DOORS WITH FULL LENGTH HANDLES
TWO (2) LOCKING LEVER LATCHES
- #5 DOOR OPENING: 12.00h x 17.00w
INSIDE DIMS: 14.00h x 21.50w x 16.25d
ONE (1) ADJUSTABLE SHELF

THIS DRAWING IS FOR REPRESENTATIONAL PURPOSES ONLY. DETAILS ARE CONCEPTUAL AND ARE SUBJECT TO CHANGE DURING DESIGN AND CONSTRUCTION DIMENSIONS ARE APPROXIMATE UNLESS NOTED OTHERWISE TO MEET A SPECIFIC CUSTOMER NEED.



2012 STREETSIDE INTERIOR VIEW
CHIEF XL-I

DATE: 05 JULY 11	DWG. GLF	REV. NR	DRAWING NO. XLF450-5
1:22			

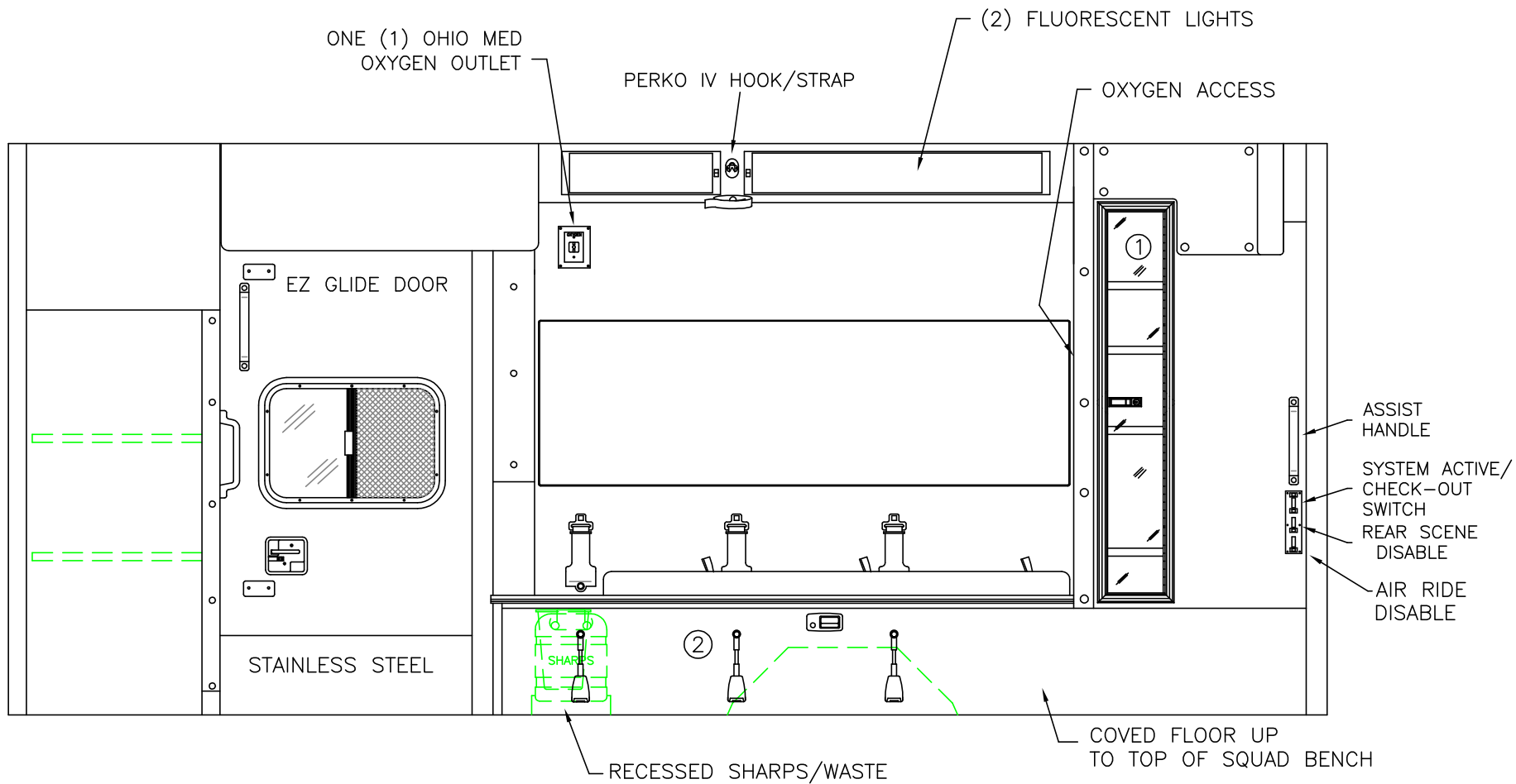

COMPARTMENT

- #1 DOOR OPENING: 48.00h x 7.25w
- INSIDE DIMS: 50.00h x 13.25w x 7.50d
- RECESSED .375" ACRYLIC DOOR
- ONE (1) LOCKING LEVER LATCH
- FOUR (4) ADJUSTABLE SHELVES
- #2 INSIDE DIM'S: 14.25h x 72.75w x 21.00d

THIS DRAWING IS FOR REPRESENTATIONAL PURPOSES ONLY. DETAILS ARE CONCEPTUAL AND ARE SUBJECT TO CHANGE DURING DESIGN AND CONSTRUCTION
 DIMENSIONS ARE APPROXIMATE UNLESS NOTED OTHERWISE TO MEET A SPECIFIC CUSTOMER NEED.



2012 CURBSIDE INTERIOR VIEW
 CHIEF XL-1

DATE:	05 JULY 11		DRAWING NO.
DWG.	GLF	REV.	NR
1:20			XLF450-6

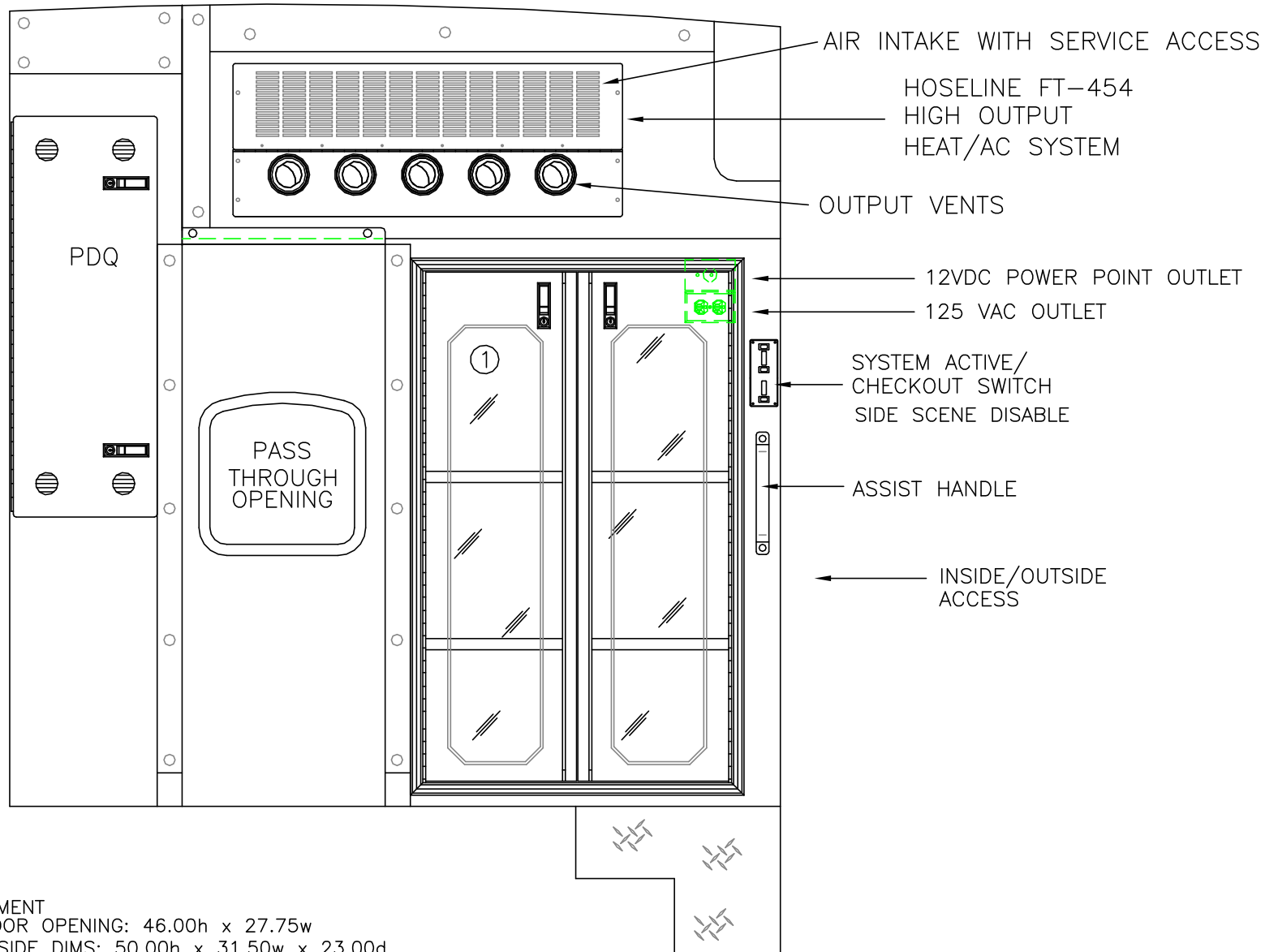

COMPARTMENT
 #1 DOOR OPENING: 46.00h x 27.75w
 INSIDE DIMS: 50.00h x 31.50w x 23.00d
 RECESSED .375" ACRYLIC DOORS WITH FULL LENGTH HANDLES
 TWO (2) LOCKING LEVER LATCHES
 TWO (2) ADJUSTABLE SHELVES

THIS DRAWING IS FOR REPRESENTATIONAL PURPOSES ONLY. DETAILS ARE CONCEPTUAL AND ARE SUBJECT TO CHANGE DURING DESIGN AND CONSTRUCTION
 DIMENSIONS ARE APPROXIMATE UNLESS NOTED OTHERWISE TO MEET A SPECIFIC CUSTOMER NEED.

2012 PARTITION INTERIOR VIEW
 CHIEF XL-1



DATE: 05 JULY 11		DRAWING NO.
DWG. GLF	REV. NR	XLF450-7

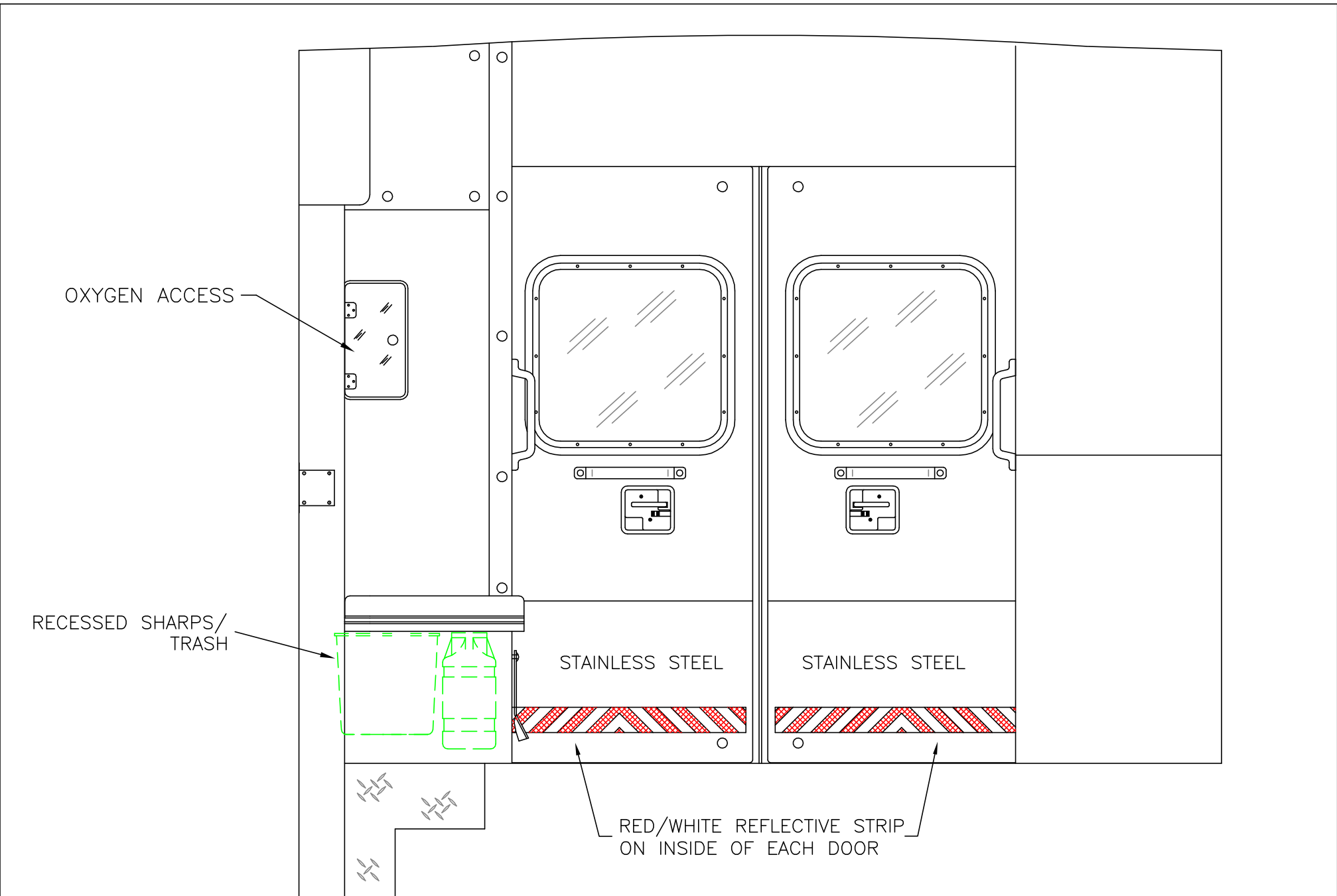

OXYGEN ACCESS

RECESSED SHARPS/
TRASH

STAINLESS STEEL

STAINLESS STEEL

RED/WHITE REFLECTIVE STRIP
ON INSIDE OF EACH DOOR

THIS DRAWING IS FOR REPRESENTATIONAL PURPOSES ONLY. DETAILS ARE CONCEPTUAL AND ARE SUBJECT TO CHANGE DURING DESIGN AND CONSTRUCTION DIMENSIONS ARE APPROXIMATE UNLESS NOTED OTHERWISE TO MEET A SPECIFIC CUSTOMER NEED.



2012 REAR INTERIOR VIEW
CHIEF XL-1

1:12

DATE:	05 JULY 11
DWG.	GLF
REV.	NR

DRAWING NO.
XLF450-8

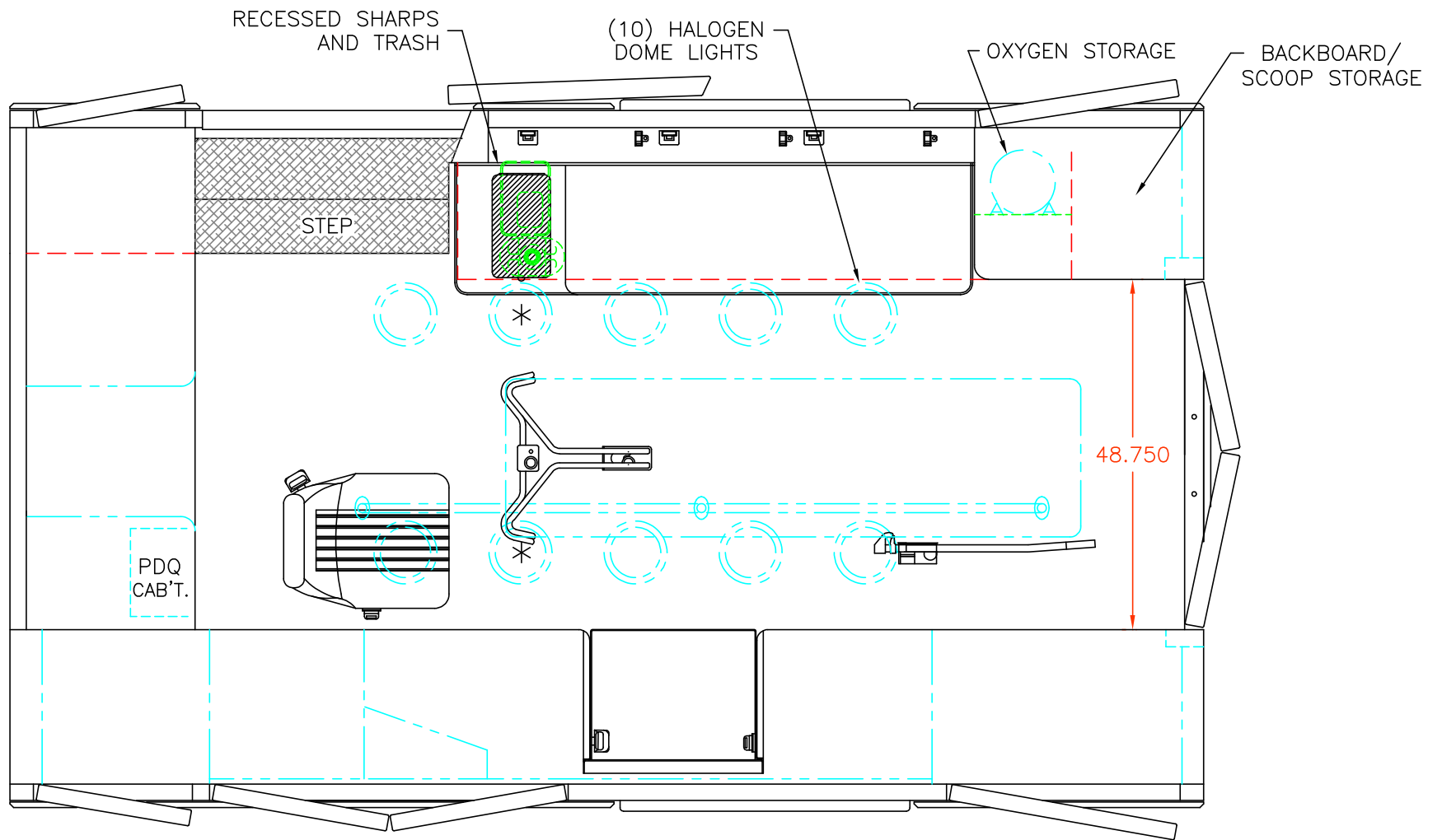

* TWO (2) ANTENNA BASES LOCATED OUTBOARD OF DOME LIGHTS WITH COAX SERVICE LOOP

STRYKER CENTER MOUNT COT HARDWARE

MODULE WIDTH = 96"
 MODULE LENGTH = 166"
 MODULE HEAD ROOM = 72.50"

THIS DRAWING IS FOR REPRESENTATIONAL PURPOSES ONLY. DETAILS ARE CONCEPTUAL AND ARE SUBJECT TO CHANGE DURING DESIGN AND CONSTRUCTION DIMENSIONS ARE APPROXIMATE UNLESS NOTED OTHERWISE TO MEET A SPECIFIC CUSTOMER NEED.



2012 FLOOR INTERIOR VIEW
 CHIEF XL-1

DATE:		DRAWING NO.	
05 JULY 11		XLF450-9	
DWG.	REV.		
GLF	NR		

1:22