

DIMENSIONS FOR OVERALL HEIGHT AND LENGTH ARE APPROXIMATE
 OVERALL HEIGHT = 105"
 OVERALL WIDTH WITH RUB
 RAILS & FENDERETTES = 95"

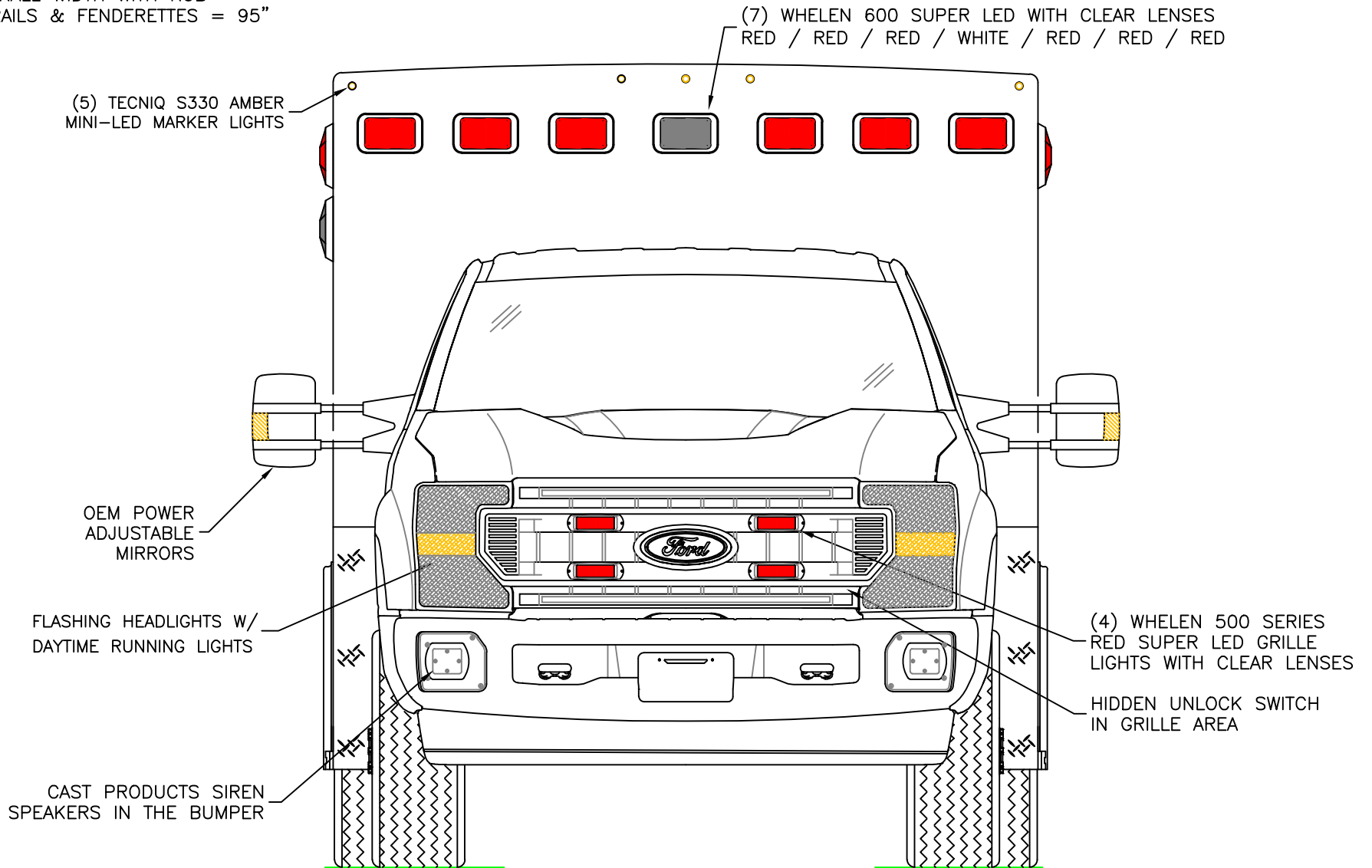

THIS DRAWING IS FOR REPRESENTATIONAL PURPOSES ONLY. DETAILS ARE CONCEPTUAL AND ARE SUBJECT TO CHANGE DURING DESIGN AND CONSTRUCTION
 DIMENSIONS ARE APPROXIMATE UNLESS NOTED OTHERWISE TO MEET A SPECIFIC CUSTOMER NEED.

BRAUN TYPE-I
 SIGNATURE SERIES



2020 FRONT EXTERIOR VIEW
 SIGNATURE SERIES-I / F-350 CHASSIS

DATE: 02-14-20	
DWG. AAB	REV. NR
DATE:	

DRAWING NO.
 SIGNATURE-1

APPROVAL SIGNATURE:

DIMENSIONS FOR OVERALL HEIGHT AND LENGTH ARE APPROXIMATE

OVERALL HEIGHT = 105"

OVERALL WIDTH WITH RUB

RAILS & FENDERETTES = 95"

(5) WHELEN 600 SUPER LED WARNING LIGHTS WITH CLEAR LENSES,
(2) WHELEN 600 CLEAR LED LOAD LIGHTS:
RED / RED / LOAD / AMBER / LOAD / RED / RED

(5) TECNIQ S330 RED
MINI-LED MARKER LIGHTS

(2) WHELEN 900 RED
SUPER LED LIGHTS
WITH CLEAR LENSES

LOCATION FOR
DOOR GRABBERS

LED LICENSE
PLATE LIGHT

(1) EACH SIDE, WHELEN
600 LED BRAKE/TAIL,
600 LED TURN
600 LED BACK-UP

MUD FLAPS

NO STANDARD AIR RIDE

INDEPENDENT BUMPER WITH
NON-SKID FLIP-UP CENTER
STEP AND COT PROTECTOR
ON STEP EDGE.

THIS DRAWING IS FOR REPRESENTATIONAL PURPOSES ONLY. DETAILS ARE CONCEPTUAL AND ARE SUBJECT TO CHANGE DURING DESIGN AND CONSTRUCTION
DIMENSIONS ARE APPROXIMATE UNLESS NOTED OTHERWISE TO MEET A SPECIFIC CUSTOMER NEED.

BRAUN TYPE-I
SIGNATURE SERIES



2020 REAR EXTERIOR VIEW
SIGNATURE SERIES-I / F-350

DATE:
02-14-20
DWG. AAB
REV. NR

DRAWING NO.
SIGNATURE-2

DIMENSIONS FOR OVERALL HEIGHT AND LENGTH ARE APPROXIMATE
 OVERALL HEIGHT = 105"
 OVERALL LENGTH = 288"
 MODULE LENGTH = 150"

NOTE: DEF FILL REMOVED IF
 GAS CHASSIS IS QUOTED.

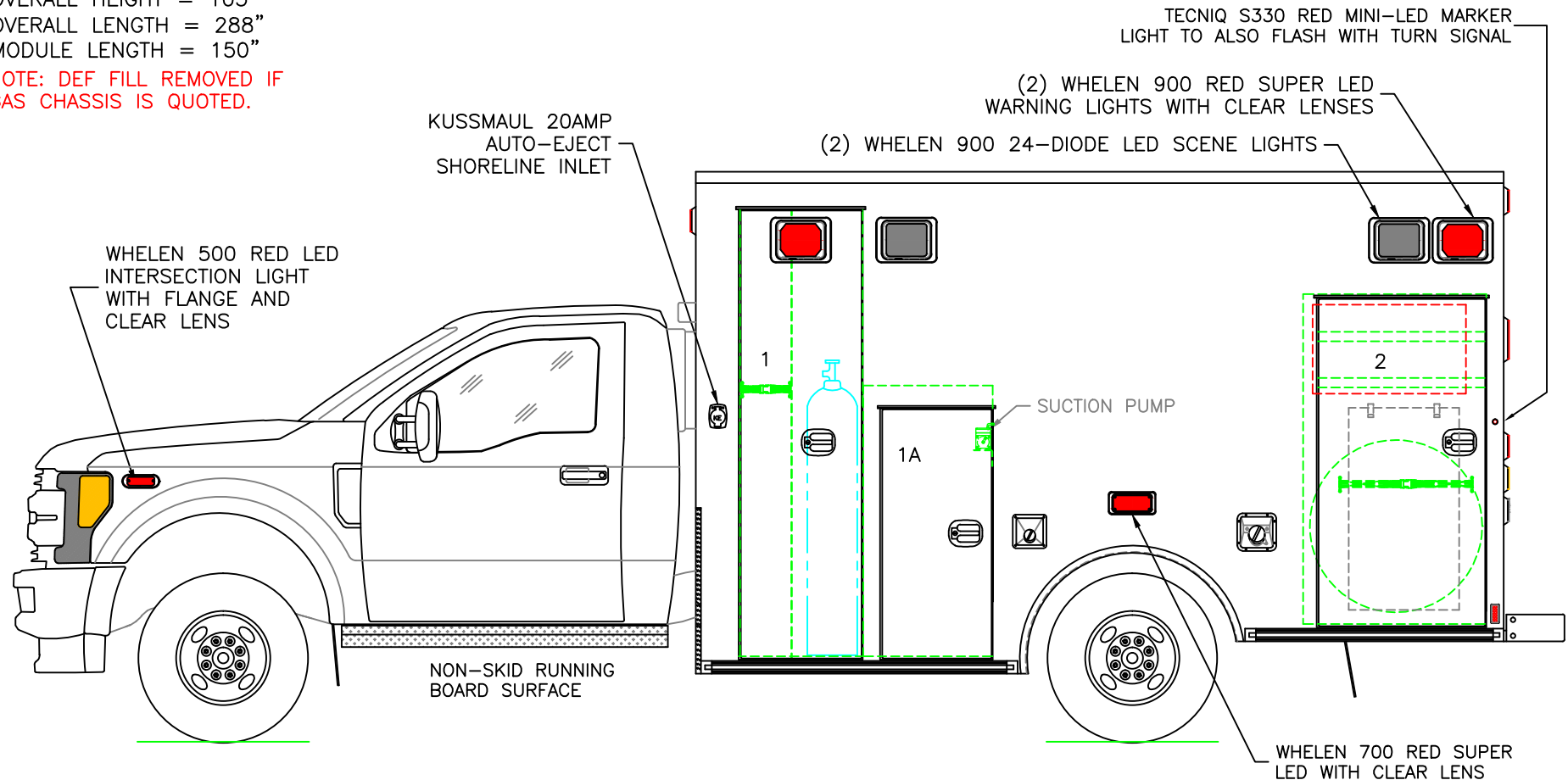

COMPARTMENT
 O.S.S #1

CLEAR OPENING: 81.75h x 19.25w
 INSIDE DIMS: 82.75h x 22.75w x 18.50d
 OXYGEN STORAGE ON RIGHT SIDE OF VERTICAL DIVIDER
 DIVIDER DEPTH = 8" TO ALLOW ALTERNATE STAIR
 CHAIR STORAGE OUTBOARD OF OXYGEN
 (1) STRAP ON LEFT SIDE OF DIVIDER
 OXYGEN BRACKET & DIVIDER TO BE BOLT-IN
 OSS & DOOR PREPPED TO HOLD THE EZ-02 LIFT

O.S.S #1A

CLEAR OPENING: 45.25h x 17.50w
 INSIDE DIM'S.: 50.25h x 24.00w x 18.50d

O.S.S #2

CLEAR OPENING: 59.50h x 28.00w
 INSIDE DIM'S.: 61.25h x 34.00w x 18.50d
 INSIDE/OUTSIDE ACCESS
 (2) ADJUSTABLE SHELVES: UPPER=FULL DEPTH; LOWER=REDUCED
 DEPTH DUE TO STAIR CHAIR ON INSIDE OF DOOR
 MOUNTING HOOKS AND STRAP ON INSIDE OF DOOR FOR
 STRYKER 6252 OR FERNO EZ-GLIDE STAIR CHAIR
 OPTIONAL SPARE TIRE STORAGE (MOUNT NOT INCLUDED AS STANDARD)
 NOTE: STAIR CHAIR AND SPARE STORAGE WILL NOT FIT AT SAME TIME

THIS DRAWING IS FOR REPRESENTATIONAL PURPOSES ONLY. DETAILS ARE CONCEPTUAL AND ARE SUBJECT TO CHANGE DURING DESIGN AND CONSTRUCTION
 DIMENSIONS ARE APPROXIMATE UNLESS NOTED OTHERWISE TO MEET A SPECIFIC CUSTOMER NEED.

BRAUN TYPE-I
 SIGNATURE SERIES



2020 STREETSIDE EXTERIOR VIEW
 SIGNATURE SERIES-I / F-350 CHASSIS

DATE:	02-14-20
DWG.:	AAB
REV.:	NR

DRAWING NO.	SIGNATURE-3
-------------	-------------

DIMENSIONS FOR OVERALL HEIGHT AND LENGTH ARE APPROXIMATE
 OVERALL HEIGHT = 105"
 OVERALL LENGTH = 288"
 MODULE LENGTH = 150"

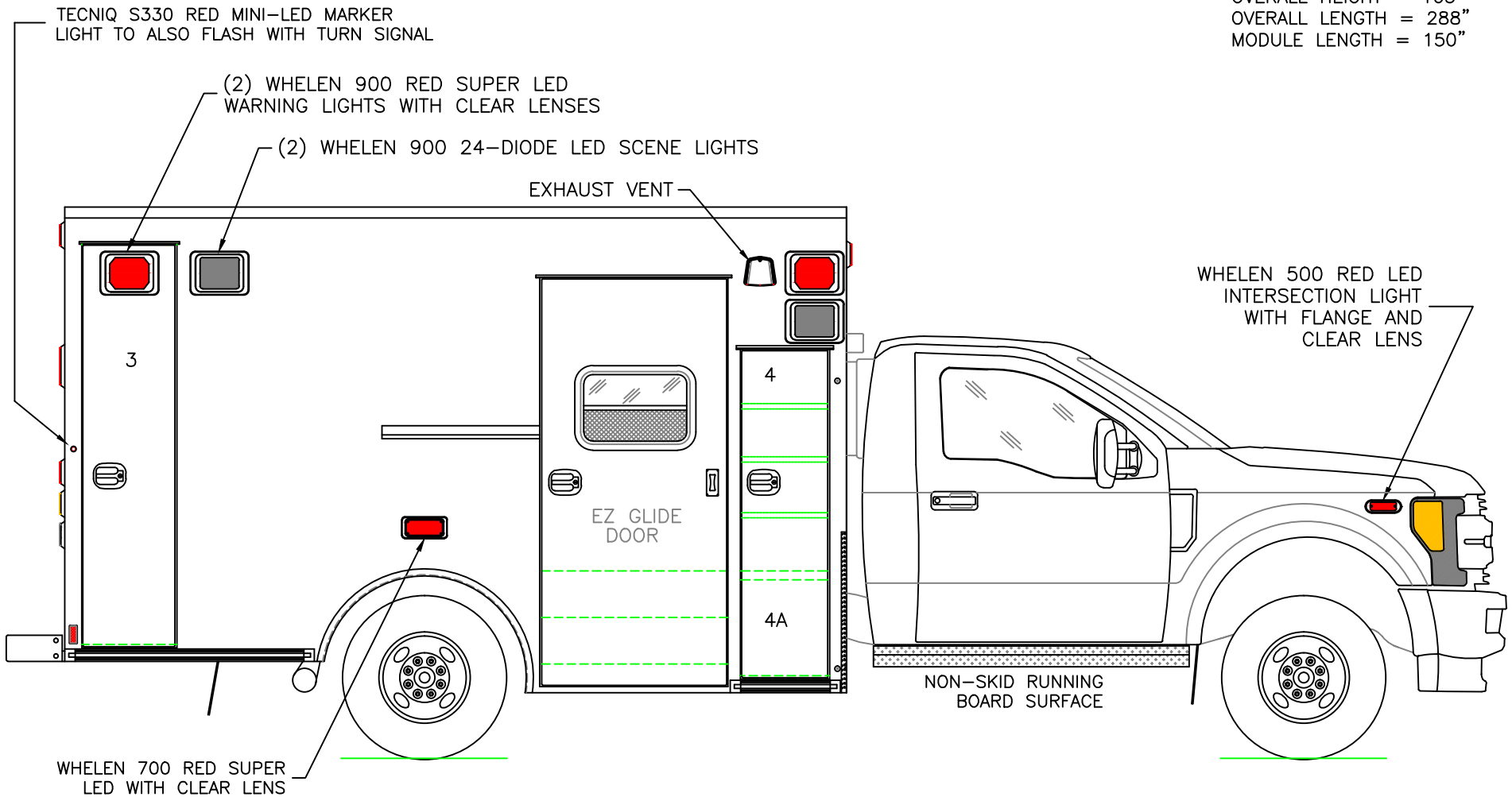

O.S.S #3
 CLEAR OPENING: 75.50h x 15.00w
 INSIDE DIM'S.: 76.75h x 18.00w x 18.50d
 BACKBOARD/SCOOP STORAGE

O.S.S #4
 CLEAR OPENING: 60.50h x 15.50w
 INSIDE DIM'S.: SEE PARTITION INTERIOR VIEW
 INSIDE/OUTSIDE ACCESS
 #4A CLEAR OPENING: 18.25h x 15.50w x 17.00d

THIS DRAWING IS FOR REPRESENTATIONAL PURPOSES ONLY. DETAILS ARE CONCEPTUAL AND ARE SUBJECT TO CHANGE DURING DESIGN AND CONSTRUCTION
 DIMENSIONS ARE APPROXIMATE UNLESS NOTED OTHERWISE TO MEET A SPECIFIC CUSTOMER NEED.

BRAUN TYPE-I
 SIGNATURE SERIES



2020 CURBSIDE EXTERIOR VIEW
 SIGNATURE SERIES-I / F-350 CHASSIS

DATE:	02-14-20
DWG.:	AAB
REV.:	NR

DRAWING NO.
 SIGNATURE-4

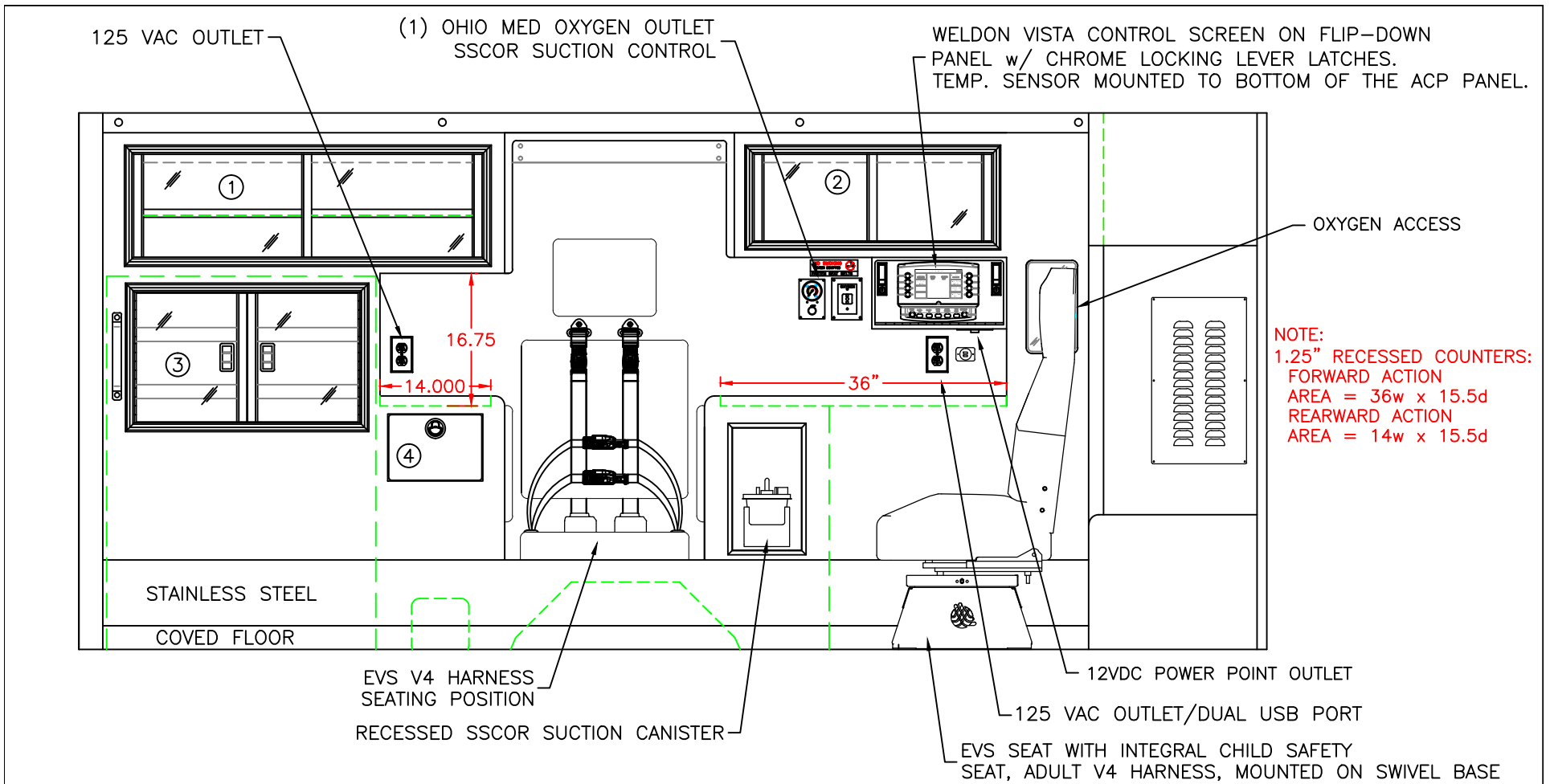

COMPARTMENT:

#1 DOOR OPENING: 13.00h x 44.00w
INSIDE DIMS: 14.75h x 45.75w x 16.25d
(1) ADJUSTABLE SHELF
SLIDING POLYCARBONATE DOORS
TOTAL CABINET WEIGHT RATING = 25 lbs.

#2 DOOR OPENING: 11.00h x 30.00w
INSIDE DIMS: 12.75h x 31.75w x 16.25d
SLIDING POLYCARBONATE DOORS
TOTAL CABINET WEIGHT RATING = 25 lbs.

#3 DOOR OPENING: 16.50h x 27.50w
INSIDE/OUTSIDE COMPARTMENT ACCESS
HINGED POLYCARBONATE DOORS WITH FULL LENGTH HANDLES
CENTER SQUEEZE LATCHES
TOTAL CABINET WEIGHT RATING = 40 lbs.

#4 PULL-OUT DRAWER
INSIDE DIMS: 7.50h x 10.00w x 15.75d
STAINLESS STEEL FLUSH PULL LATCH
TOTAL DRAWER WEIGHT RATING = 10 lbs.

CABINETS TO BE ALUMINUM

THIS DRAWING IS FOR REPRESENTATIONAL PURPOSES ONLY. DETAILS ARE CONCEPTUAL AND ARE SUBJECT TO CHANGE DURING DESIGN AND CONSTRUCTION
DIMENSIONS ARE APPROXIMATE UNLESS NOTED OTHERWISE TO MEET A SPECIFIC CUSTOMER NEED.

BRAUN TYPE-I
SIGNATURE SERIES



2020 STREETSIDE INTERIOR
SIGNATURE SERIES-I

DATE:	02-14-20
DWG.	AAB
REV.	NR

DRAWING NO.
SIGNATURE-5
WITH CPR SEAT

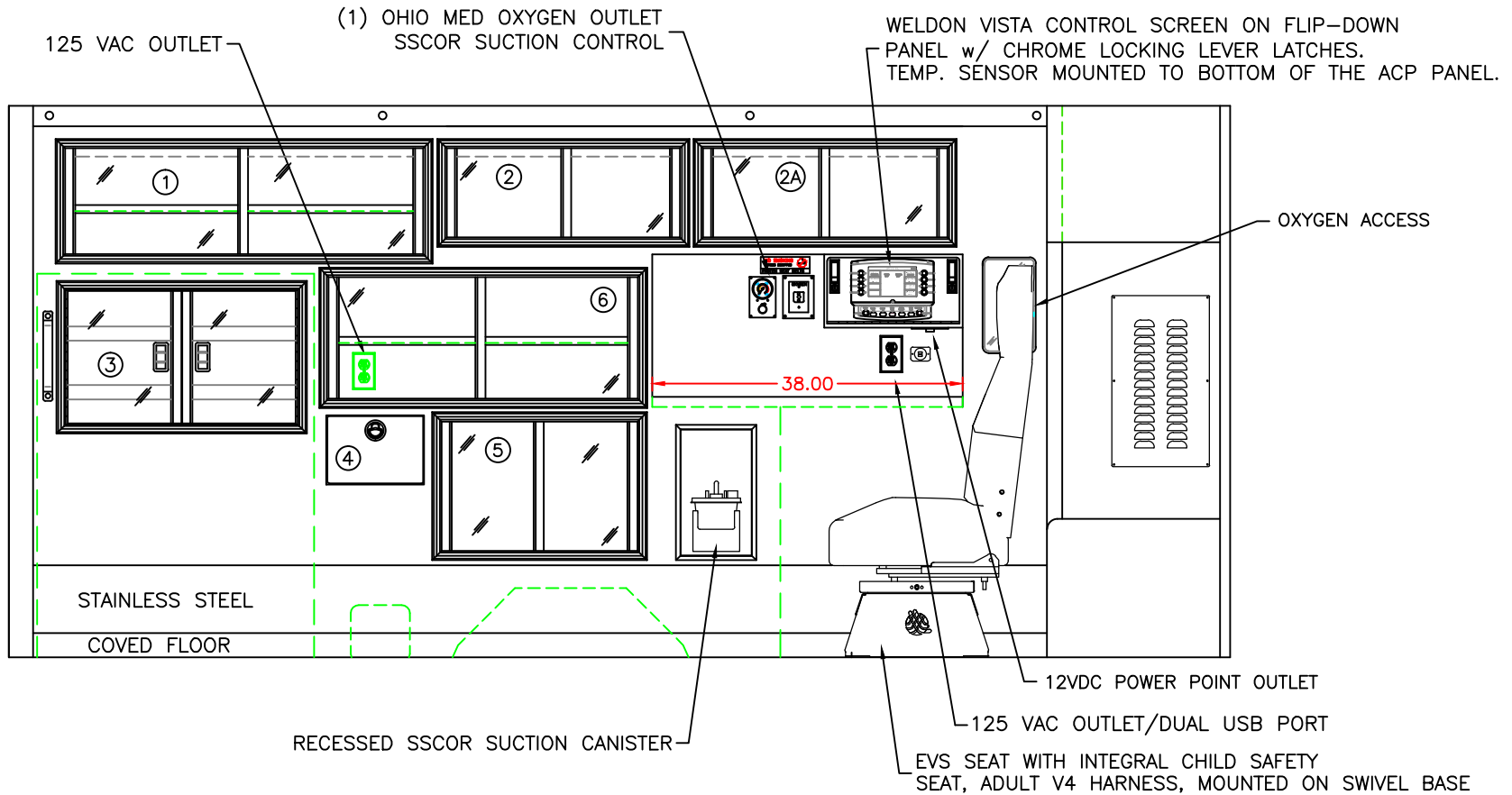

COMPARTMENT:

- #1 DOOR OPENING: 13.00h x 44.00w
 INSIDE DIMS: 14.75h x 45.75w x 16.25d
 (1) ADJUSTABLE SHELF
 SLIDING POLYCARBONATE DOORS
 TOTAL CABINET WEIGHT RATING = 25 lbs.
- #2 DOOR OPENING: 11.00h x 30.00w
 INSIDE DIMS: 12.75h x 31.75w x 16.25d
 SLIDING POLYCARBONATE DOORS
 TOTAL CABINET WEIGHT RATING = 25 lbs.
- #2A DOOR OPENING: 11.00h x 30.00w
 INSIDE DIMS: 12.75h x 31.75w x 16.25d
 SLIDING POLYCARBONATE DOORS
 TOTAL CABINET WEIGHT RATING = 25 lbs.

- #3 DOOR OPENING: 16.50h x 27.50w
 INSIDE/OUTSIDE COMPARTMENT ACCESS
 HINGED POLYCARBONATE DOORS WITH FULL LENGTH
 HANDLES CENTER SQUEEZE LATCHES
 TOTAL CABINET WEIGHT RATING = 40 lbs.
- #4 PULL-OUT DRAWER
 INSIDE DIMS: 7.50h x 10.00w x 15.75d
 STAINLESS STEEL FLUSH PULL LATCH
 TOTAL DRAWER WEIGHT RATING = 10 lbs.
- #5 DOOR OPENING: 15.75h x 24.00w
 INSIDE DIMS: 17.50h x 25.75w x 16.25d
 SLIDING POLYCARBONATE DOORS
 TOTAL CABINET WEIGHT RATING = 25 lbs.

- #6 DOOR OPENING: 15.00h x 38.00w
 INSIDE DIMS: 16.75h x 39.75w x 16.25d
 (1) ADJUSTABLE SHELF
 SLIDING POLYCARBONATE DOORS
 TOTAL CABINET WEIGHT RATING = 25 lbs.

CABINETS TO BE ALUMINUM

THIS DRAWING IS FOR REPRESENTATIONAL PURPOSES ONLY. DETAILS ARE CONCEPTUAL AND ARE SUBJECT TO CHANGE DURING DESIGN AND CONSTRUCTION
 DIMENSIONS ARE APPROXIMATE UNLESS NOTED OTHERWISE TO MEET A SPECIFIC CUSTOMER NEED.

BRAUN TYPE-I
 SIGNATURE SERIES



2020 STREETSIDE INTERIOR
 SIGNATURE SERIES-I

DATE:	02-14-20
DWG.	AAB
REV.	NR

DRAWING NO.	SIGNATURE-5
	NO CPR SEAT

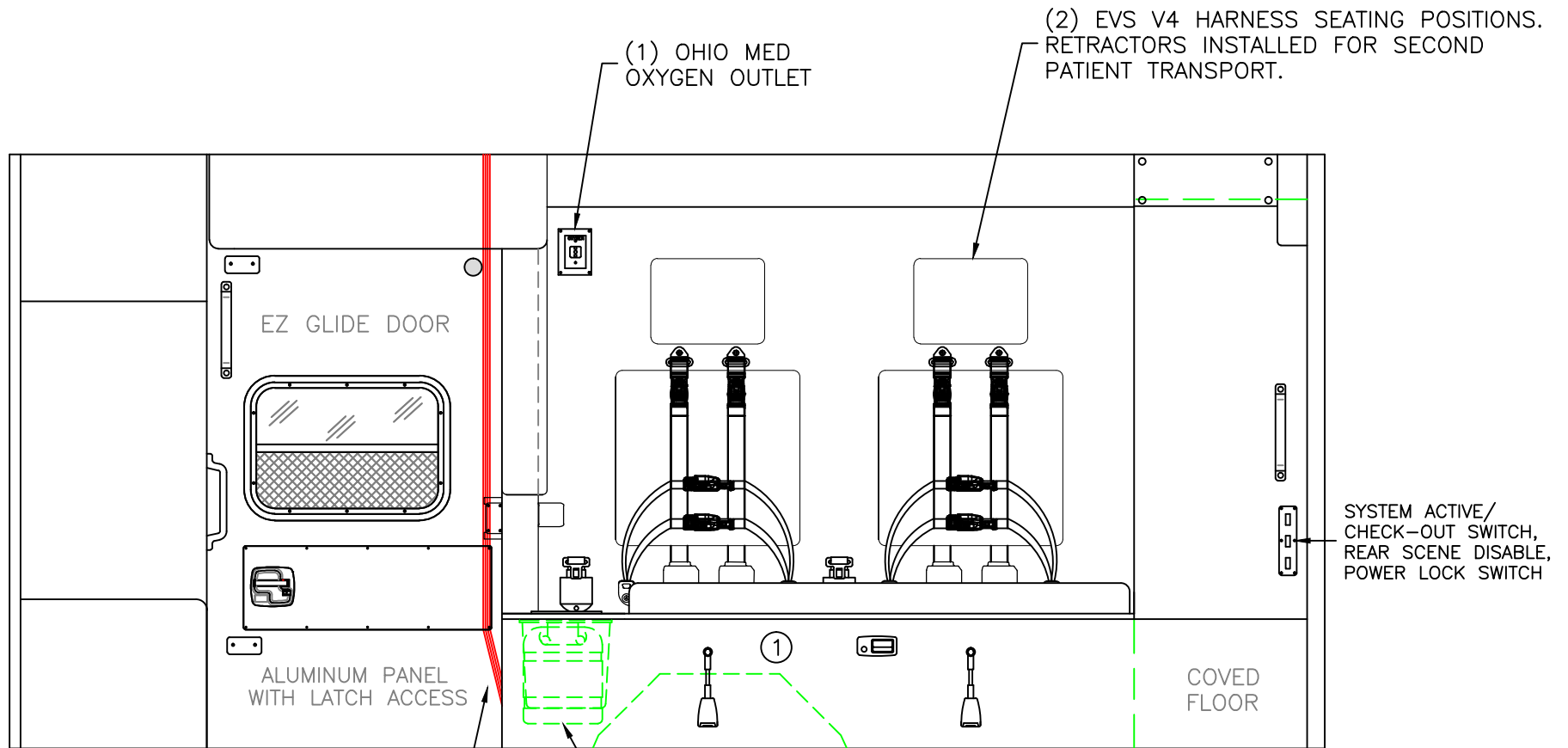

COMPARTMENT

#1 INSIDE DIMS: 15.50h x 72.00w x 18.50d

CABINETS TO BE ALUMINUM

THIS DRAWING IS FOR REPRESENTATIONAL PURPOSES ONLY. DETAILS ARE CONCEPTUAL AND ARE SUBJECT TO CHANGE DURING DESIGN AND CONSTRUCTION DIMENSIONS ARE APPROXIMATE UNLESS NOTED OTHERWISE TO MEET A SPECIFIC CUSTOMER NEED.

BRAUN TYPE-I
SIGNATURE SERIES



2020 CURBSIDE INTERIOR VIEW
SIGNATURE SERIES-I

DATE: 02-14-20	
DWG. AAB	REV. NR

DRAWING NO.
SIGNATURE-6

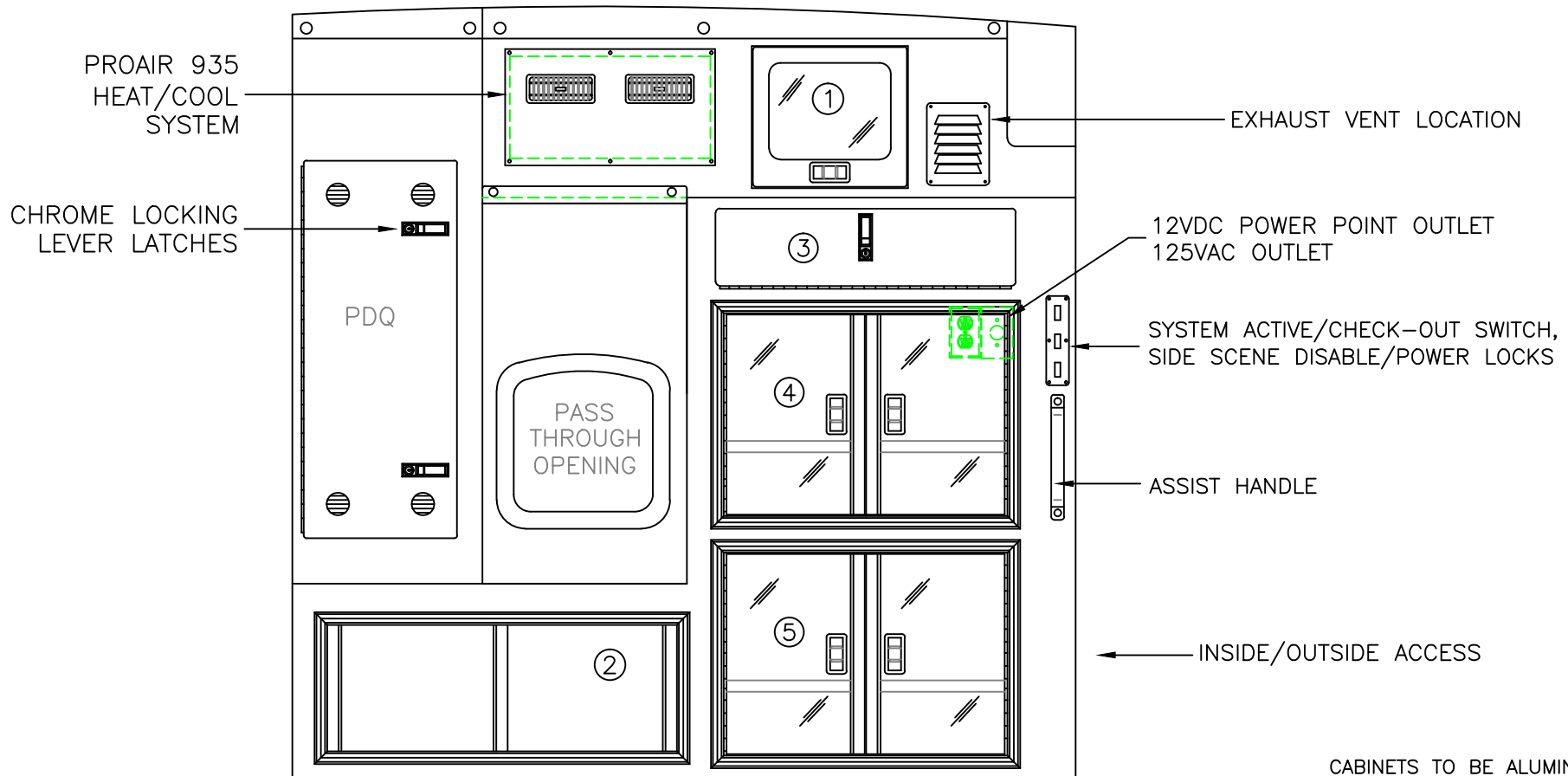

COMPARTMENT

#1 DOOR OPENING: 12.25h x 13.75w
 INSIDE DIMS: 12.25h x 13.75w x 19.75d
 HINGED ALUMINUM DOOR WITH POLYCARBONATE INSERT
 CENTER SQUEEZE LATCH AND HOLD-OPENS
 TOTAL CABINET WEIGHT RATING = 10 lbs.

#2 DOOR OPENING: 11.00h x 30.50w
 INSIDE DIMS: 16.00h x 34.00w x 14.00d
 ACTUAL DIMENSIONS MAY VARY
 ALUMINUM SLIDING DOORS
 TOTAL CABINET WEIGHT RATING = 25 lbs.

#3 DROP-DOWN HINGED ALUMINUM DOOR
 WITH CHROME LOCKING LEVER LATCH
 OPENING DIMS: 6.50h x 26.00w
 INSIDE DIMS: 7.50h x 26.00w x 20.00d
 TOTAL CABINET WEIGHT RATING = 15 lbs.

#4/#5 DOOR OPENING: 17.75h x 25.00w
 INSIDE DIMS: 19.25h x 27.75w x 20.00d
 HINGED POLYCARBONATE DOORS WITH FULL LENGTH HANDLES
 CENTER SQUEEZE LATCHES
 (1) ADJUSTABLE SHELF PER COMPARTMENT
 TOTAL CABINET WEIGHT RATING = 60 lbs. EACH

THIS DRAWING IS FOR REPRESENTATIONAL PURPOSES ONLY. DETAILS ARE CONCEPTUAL AND ARE SUBJECT TO CHANGE DURING DESIGN AND CONSTRUCTION
 DIMENSIONS ARE APPROXIMATE UNLESS NOTED OTHERWISE TO MEET A SPECIFIC CUSTOMER NEED.

BRAUN TYPE-I
 SIGNATURE SERIES



2020 PARTITION INTERIOR VIEW
 SIGNATURE SERIES-I

DATE: 02-14-20	
DWG. AAB	REV. NR

DRAWING NO.
SIGNATURE-7

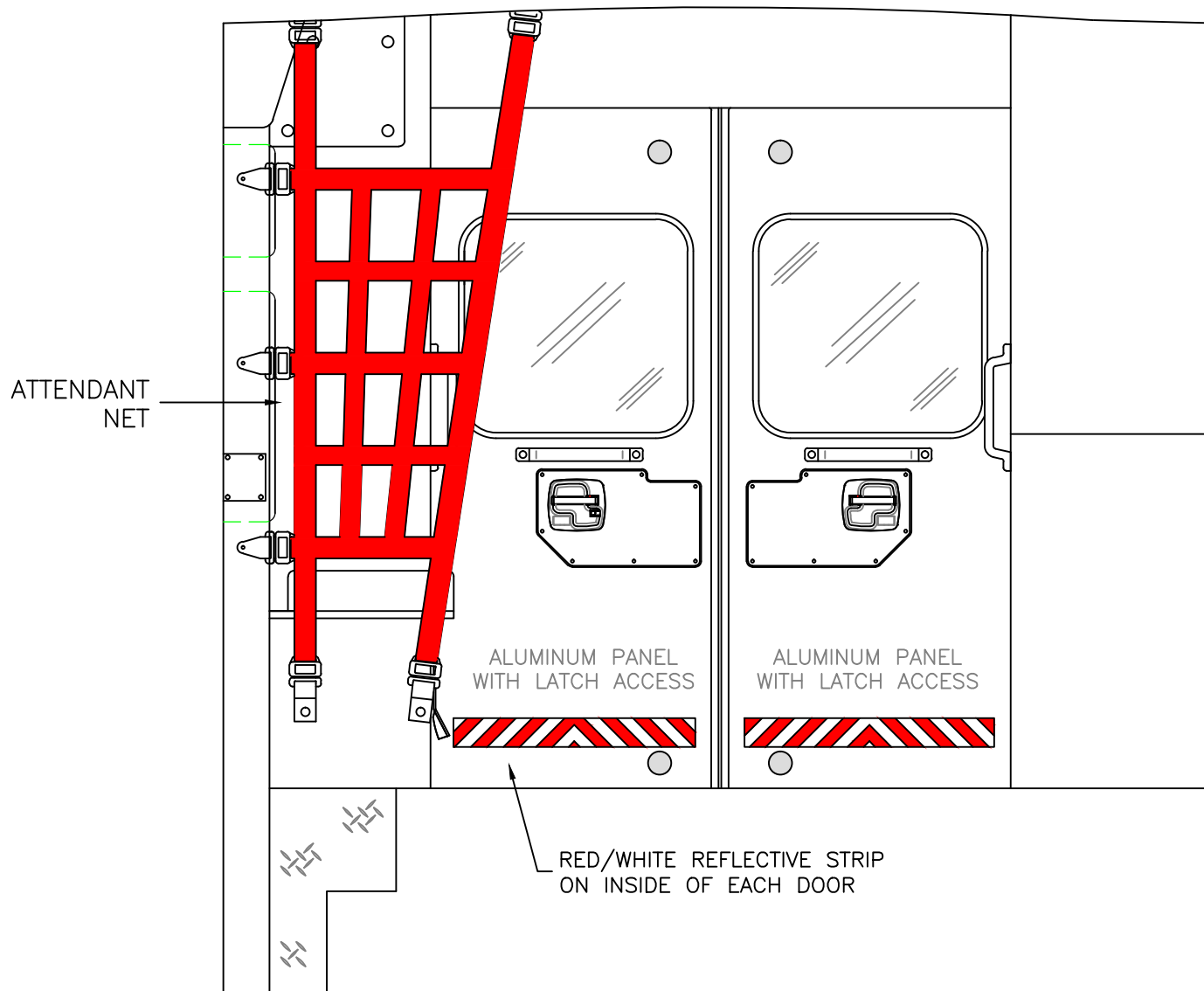

THIS DRAWING IS FOR REPRESENTATIONAL PURPOSES ONLY. DETAILS ARE CONCEPTUAL AND ARE SUBJECT TO CHANGE DURING DESIGN AND CONSTRUCTION DIMENSIONS ARE APPROXIMATE UNLESS NOTED OTHERWISE TO MEET A SPECIFIC CUSTOMER NEED.

BRAUN TYPE-I
SIGNATURE SERIES



2020 REAR INTERIOR VIEW
SIGNATURE SERIES-I

DATE:	02-14-20
DWG.	AAB
REV.	NR

DRAWING NO.	SIGNATURE-8
-------------	-------------

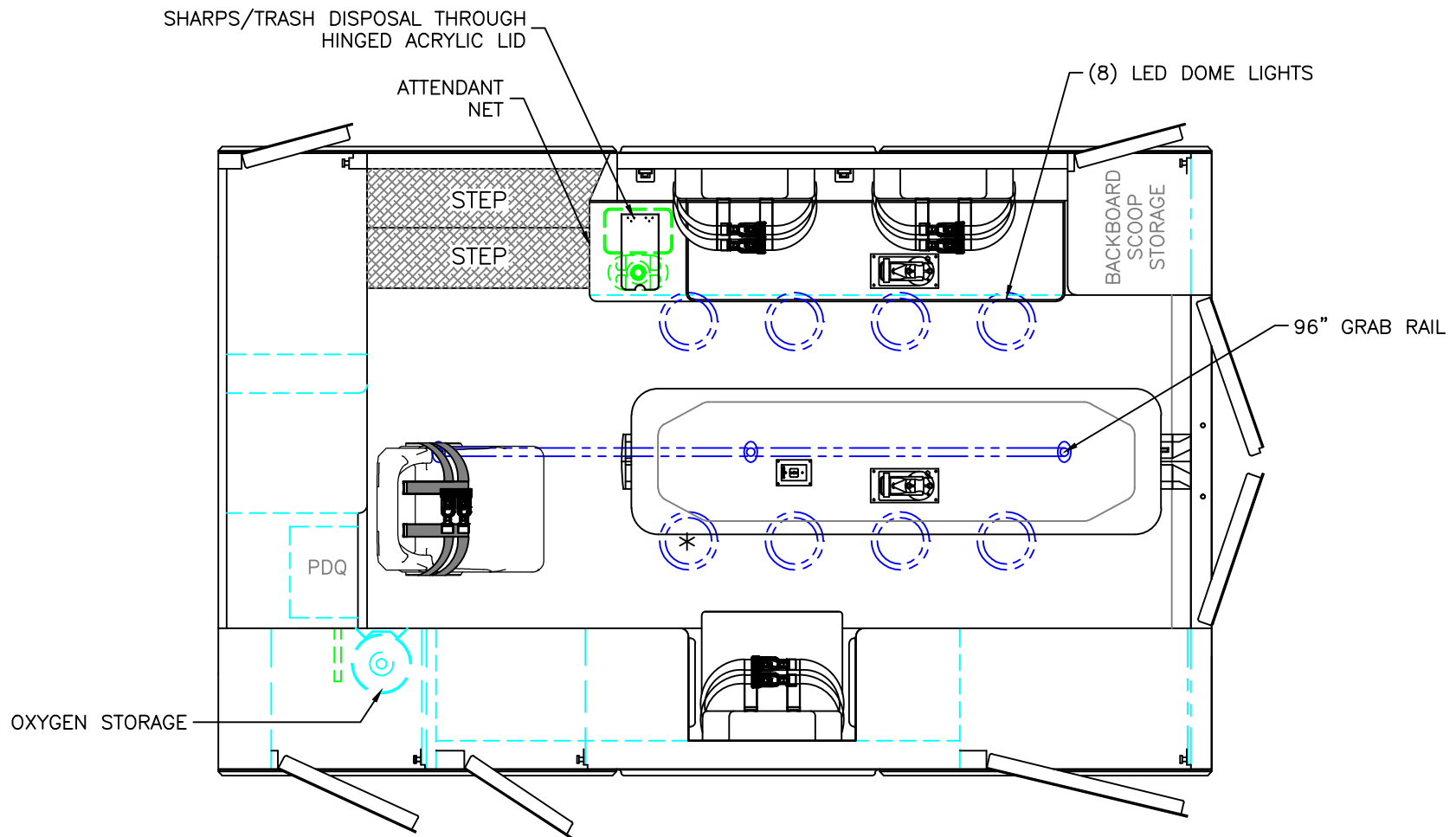

* (1) ANTENNA BASE LOCATED OUTBOARD OF DOME LIGHT WITH COAX SERVICE LOOP

86" FERNO STAT-TRAC CENTER MOUNT COT HARDWARE

 = (2) RECESSED CAST PRODUCTS CEILING IV HANGERS

 = (1) CEILING OXYGEN OUTLET

HEAD ROOM = 68"
 OVERALL WIDTH WITH RUB
 RAILS & FENDERETTES = 95"
 MODULE LENGTH = 150"

THIS DRAWING IS FOR REPRESENTATIONAL PURPOSES ONLY. DETAILS ARE CONCEPTUAL AND ARE SUBJECT TO CHANGE DURING DESIGN AND CONSTRUCTION
 DIMENSIONS ARE APPROXIMATE UNLESS NOTED OTHERWISE TO MEET A SPECIFIC CUSTOMER NEED.

BRAUN TYPE-I
 SIGNATURE SERIES



2020 FLOOR VIEW
 SIGNATURE SERIES-1

DATE: 02-14-20	
DWG. AAB	REV. NR

DRAWING NO.
 SIGNATURE-9
 WITH CPR SEAT

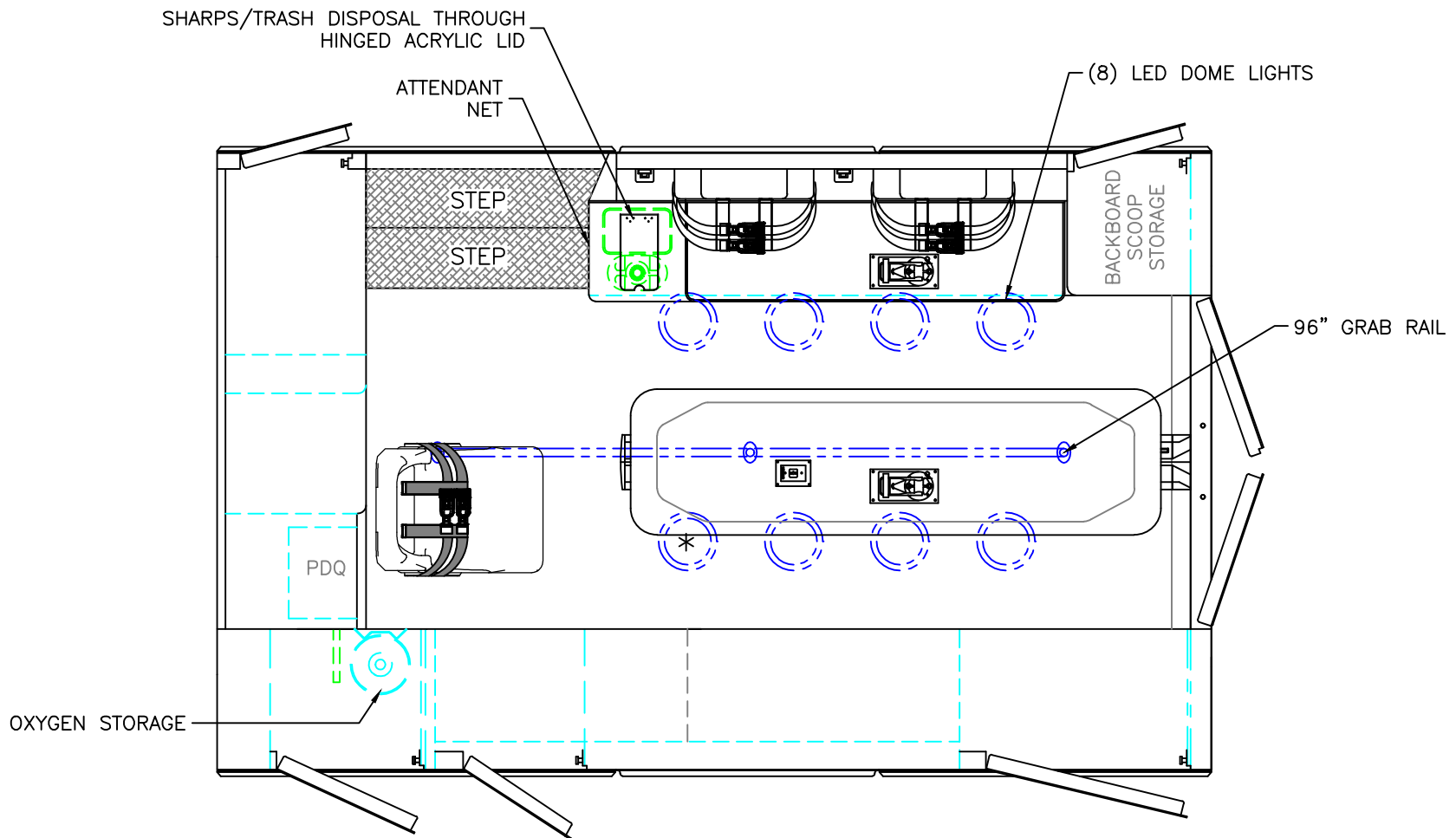

* (1) ANTENNA BASE LOCATED OUTBOARD OF DOME LIGHT WITH COAX SERVICE LOOP

86" FERNO STAT-TRAC CENTER MOUNT COT HARDWARE

 = (2) RECESSED CAST PRODUCTS CEILING IV HANGERS

 = (1) CEILING OXYGEN OUTLET

HEAD ROOM = 68"
 OVERALL WIDTH WITH RUB
 RAILS & FENDERETTES = 95"
 MODULE LENGTH = 150"

THIS DRAWING IS FOR REPRESENTATIONAL PURPOSES ONLY. DETAILS ARE CONCEPTUAL AND ARE SUBJECT TO CHANGE DURING DESIGN AND CONSTRUCTION
 DIMENSIONS ARE APPROXIMATE UNLESS NOTED OTHERWISE TO MEET A SPECIFIC CUSTOMER NEED.

BRAUN TYPE-I
 SIGNATURE SERIES



DATE: 02-14-20	
DWG. AAB	REV. NR

DRAWING NO.
 SIGNATURE-9
 NO CPR SEAT